

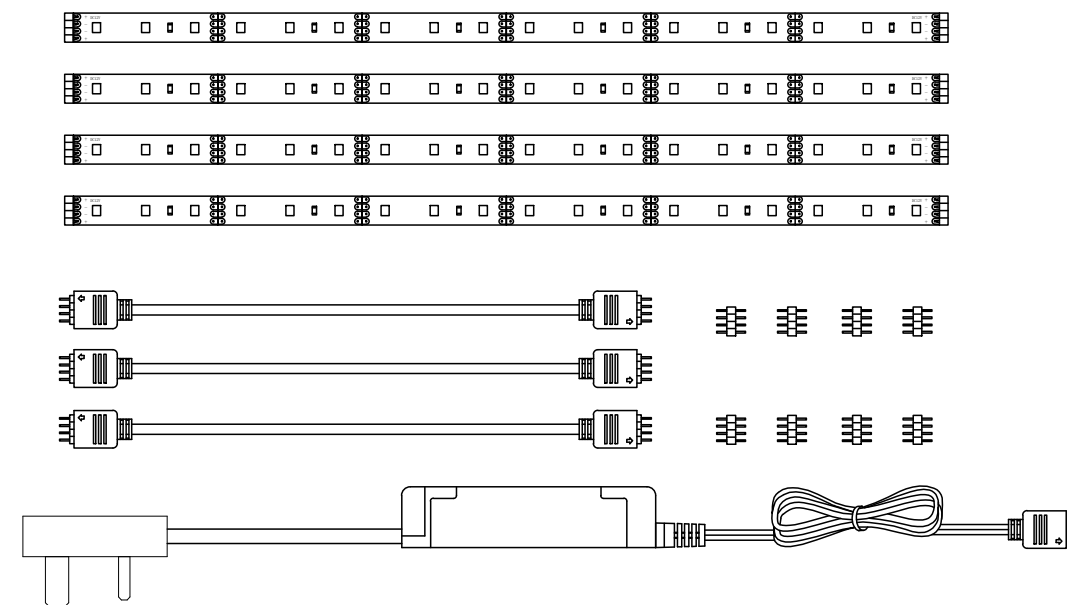

Atollo 4lt Cabinet Flexi LED Strip White

SKU 3142934



Care & Instruction Manual

For household and indoor use only

Please read and retain these instructions for future reference

To help you get the most from your new light fitting, we offer the following guidelines to assist you. Some experience of electrical wiring and do-it-yourself is required to install the light fitting. If at any time you are unsure how to proceed, **please consult a qualified electrician.**

Contents:

- 1x In-line driver with UK 3 Pin Plug
- 1x 0.5m Mains & 1.5m LV extension cable
- 4x 300mm LED strips
- 3x 150mm extension cables
- 8x Short 4 pin connectors

Important

This kit is a Class 2 product and operates at Safety Extra Low Voltage (SELV). It must be connected to an earth circuit.

For your safety, this product must be installed in accordance with wiring regulations from the Institute of Engineering and Technology (IET) and current local Building Regulations. If you are in doubt regarding the installation of this product consult a qualified electrician. To prevent electrocution switch off from the mains when maintaining or installing this kit. This kit contains non-replaceable parts and cannot be serviced. If damage occurs the part should be scrapped. Ensure cables are safely routed to avoid accidental damage or hazard. The light source/control gear contained in this luminaire is not replaceable, when the light source/control gear reaches its end of life the whole luminaire shall be replaced. This product contains a light source of energy efficiency class G.

Before Starting

Please read through these instructions before commencing work, and keep them for future reference.

Layout

This kit comprises of 4x 300mm LED strips. It will operate with just one strip connected and up to the total number supplied in the kit. Additional strips cannot be added. Plan the desired layout of the these fitting carefully, ensuring the cables will reach the distances between the transformer and each LED strip.

This product is designed for under kitchen cupboards, bookshelves, cabinets etc. Suitable for indoor use only. Not suitable for bathrooms.

Do not attach to surfaces which are damp, freshly painted or otherwise electrically conductive (e.g. metallic surfaces).

The chosen location should allow for the product to be securely mounted and safely connected to the mains supply (240V wall socket).

Ensure that there is adequate ventilation for the LED driver.

Avoid locating any cables in positions that would cause a hazard. Position cables and connector block away from areas where they may be at risk from being cut, trapped or damaged.

Cables that are to be in walls must be protected using suitable conduit or plastic trunking.

Please note that the LED strips are flexible. Whilst they will take a certain amount of bending, they must not be folded.

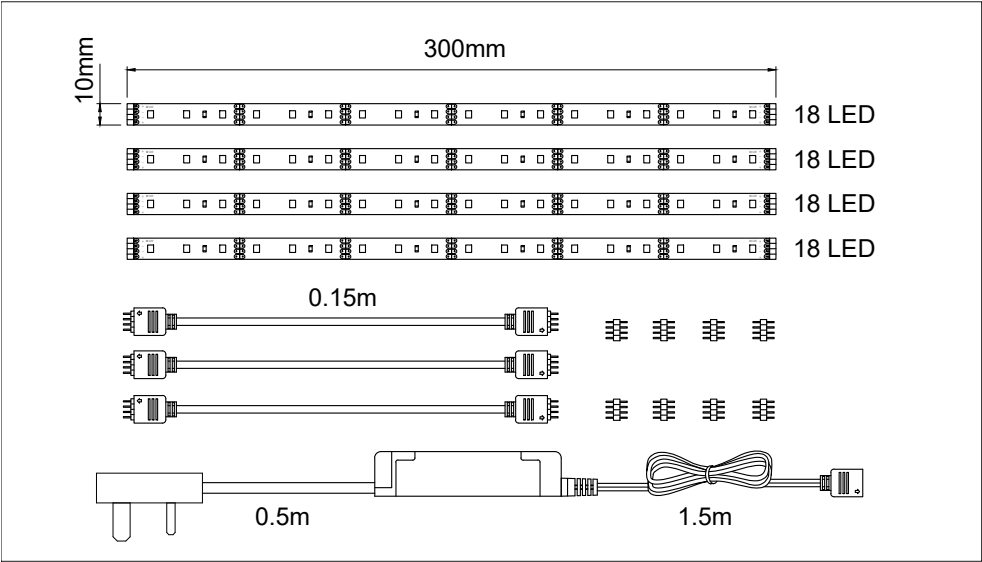

Installation

Layout and measure the positions of the strips as desired. Ensure cables are routed to avoid accidents or damage occurring. Cables can be taped to mounting surface after installation.

Connect one strip to the driver output cable, route loom to desired power source. (240V mains socket)

Cables can be tidied and secured to the mounting surface using tape or small clips (not supplied).

The other 3 strips can be linked in one of two ways, as shown below:

- via the 4 pin connectors, or
- via the extension cables.

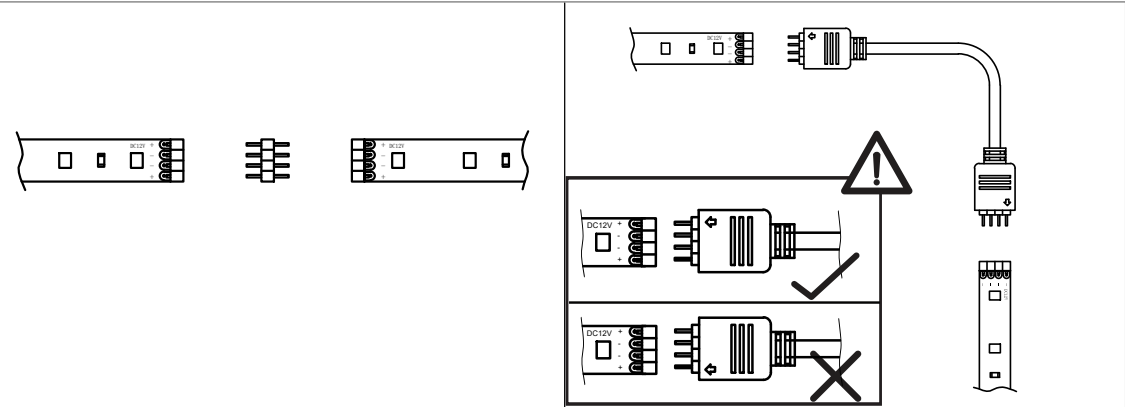

Check all connections are tight.

Plug in LED driver and test.

Peel the adhesive backing off of the strips and stick in place.

Your LED lighting kit is now ready to use.

BULB REPLACEMENT

LED Light Source: Non-replaceable (8W LED)

Care and cleaning:

Always switch off or disconnect from the mains when cleaning the product.

We recommend cleaning with a soft dry cloth. Never use scourers, abrasives or chemical cleaners.

Do not allow moisture to come into contact with electric parts.

Recycling electrical products

You should now recycle your waste electrical goods and in doing so help the environment. This symbol means an electrical product should not be disposed of with normal household waste. Please ensure it is taken to a suitable facility for disposal.

Visit www.recycle-more.co.uk, click on “bank locator” and enter your postcode to find your nearest recycling site.

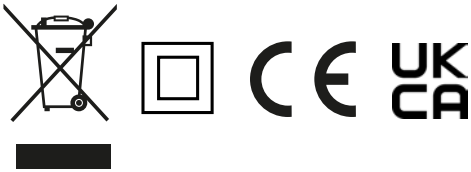

If you require any further assistance, you can contact us on 0345 640 2020 or visit argos.co.uk

Produced in China. Sainsbury's Supermarkets Ltd, London, EC1N 2HT, UK. Sainsbury's (NI) Ltd, Forestside Shopping Centre, Upper Galwally, Belfast, BT8 6FX, UK.